

TECA South Zone Championships

March 30, 2019



TECA Sanctioned Event sponsored by

The Rivera High School Band Boosters and

Rivera Band Program

Rivera High School Gymnasium

I. Location, Directions

- The South Zone Championships will be held at Rivera High School, located at:

6955 Ruben M Torres Blvd, Brownsville Texas 78521

Entering Brownsville:

- Take the exit toward Farm to Market Rd 802/Ruben M Torres Sr Blvd/US-77 BUS
- Merge onto Frontage Road, taking left turn at Ruben M. Torres Blvd.
- Travel straight for approx. 6 miles on Ruben M. Torres
 - **Buses-** Cross Vermillion Ave. and take last exit to school parking lot in front of School. You may follow bus path around parking lot to drop off at front of school.
 - **Spectator-** Cross Vermillion Ave. and take first or second entrance to spectator parking lot
 - **Equipment Truck/Overflow Parking-** Take left turn onto Vermillion Ave. and travel to parking lot in rear of school. **Use the rear entrance to school to unload any props and tarps directly into the Prop Storage area across from performance Gym.**

II. Contest Flow

All contest rules and regulations from the 2019 TECA Constitution and By-Laws and the 2019 TECA and WGI Rule Books will be followed.

Parking

- All Spectators parking will be in the front (South Side) of the Campus.
- All Unit buses will park on the Marching Band Field, Over Flow Rear Parking and if needed Vermillion Elementary School Parking. Information regarding the elementary school will be given on a need to know basis.
- All Equipment trucks will park in rear of school with direct access to prop storage area. **Please notify contest host prior to arriving if you plan to bring any particularly large equipment vehicles, for whatever reason.**
- Staff and Security will be available to aid in parking of buses and equipment trucks.

Check In/Holding Areas

- The check in table will be located at the Main entrance of the school.
- Maps of the school and performance times will be available.
- You will be assigned a student liaison who will direct you to your designated holding room/cafeteria.
 - Holding Room- Each unit/school will be designated a class room as a holding area to alleviate congestion in the cafeteria and give a quieter space to prepare for performance. These rooms may be used to store bags, equipment, and do any costuming or make up you may have for the show. These rooms will be available from your CHECK IN time to 45 minutes follow your performance time by which time all belongings must be taken from room to buses or cafeteria.

Guard, Crew and Staff Admission

- Performing members and crew members will need to check in at the “check in table” prior to warm up. Stamps will be issued to performing unit, 2 directors plus 10 student crew members.

Cafeteria Area / Warm Up Area/Prop Storage

- **We will be hosting a UIL Region Academic meet at Rivera the same day as contest. These students will also be held in the cafeteria. Please do not leave belongings unsupervised in this area.**
- **ALL FOODS AND BEVERAGES MUST BE CONSUMED IN CAFETERIA.**
- Props/Floors and larger equipment may be stored in the designated prop storage area which is accessible direction from rear parking lot or through front school foyer.
- If you need an extra equipment warm-up, you may do so outside in the designated warm up area (refer to map).
- Additional equipment warm up areas will be located outside and in the Indoor Athletics Facility. Please see map for details regarding any warm up areas.

ALL AREAS BEYOND THE READY TABLE AND PROP STORAGE WILL BE DESIGNATED QUIET ZONES

Official Warm-Up Time

- Body Warm-Up, Equipment Warm-Up and Performance Notes
 - When it is time for your guard to be “READY” according to the schedule, please report to the “READY TABLE” located in the main high school hall way, adjacent to the Concession Stand. You will be escorted by a monitor to each warm up area and to the performance gym.
 - Body warm up will be in the Rivera Dance Room. Students may stretch or do a body type of run through. No equipment will be utilized during this segment of the official warm up time.
 - After body warm up, your guard will be led to the Band Hall for equipment warm up. The floor to the band hall will be slightly smaller than a full size floor, but will be ample space for your guard to spin.
 - After your equipment warm-up, your guard will be led through the prop storage area to the rear door of the performance gym.

WE WILL BE UTILIZING A VERTICAL TIME LINE FOR THE PERFORMANCE AREA.

From audience perspective, you will enter from the back left and exit to the back right.

- **Post Performance**
 - After you exit the performance area, you will be guided through a hall way to an outside tarp folding area. In the case of wind or rain the Indoor Athletic facility (please see map) will be used to facilitate tarp folding.
 - Judges’ comments will be delivered electronically through Competition Suite. O
 - There will be a single full guard retreat scheduled at the end of the day.
 - If you have a problem with any of your judges’ comments, you will need to fill out the WGI Color Guard Instructors Evaluation Form from your 2019 WGI Color Guard and Adjudication Manual and Rule Book.
 -

III. Admission (Spectators)

- Student \$10.00 Adult \$15.00 Admission is good for the entire day. Children 5 and under are FREE.
- TECA Championship Programs will be sold for \$3
- Wristbands will be provided. You must show your wristband to enter the performance area.
- Air Grams will also be available for purchase, 10 per competing unit. Rates will be one for \$3 or two for 5\$.

IV. Concessions

- Concessions will be available to everyone outside the HS Gym. Typical Concessions will be available with some more limited qualities of meal type items. Pre-planned meals will be available to units through the Rivera Band Booster program.
 - Brisket Sandwich \$5
 - Nachos 3\$
 - Gatorade/Powerade \$3
 - Hot Cheetos/Cheese \$2
 - Frito Pie \$2
 - Pizza \$2
 - Candies \$2
 - Soda \$2
 - Chips \$1
 - Pickles \$1

V. Online help and Information

You may get online information and help via the TECA website at <http://www.go-teca.org> If you have any direct questions for me as the show host, my email is d_villanueva13@yahoo.com. My cell phone is 505-307-3255-----

Daniel Villanueva , Rivera HS Assistant Director of Bands, Color Guard Director



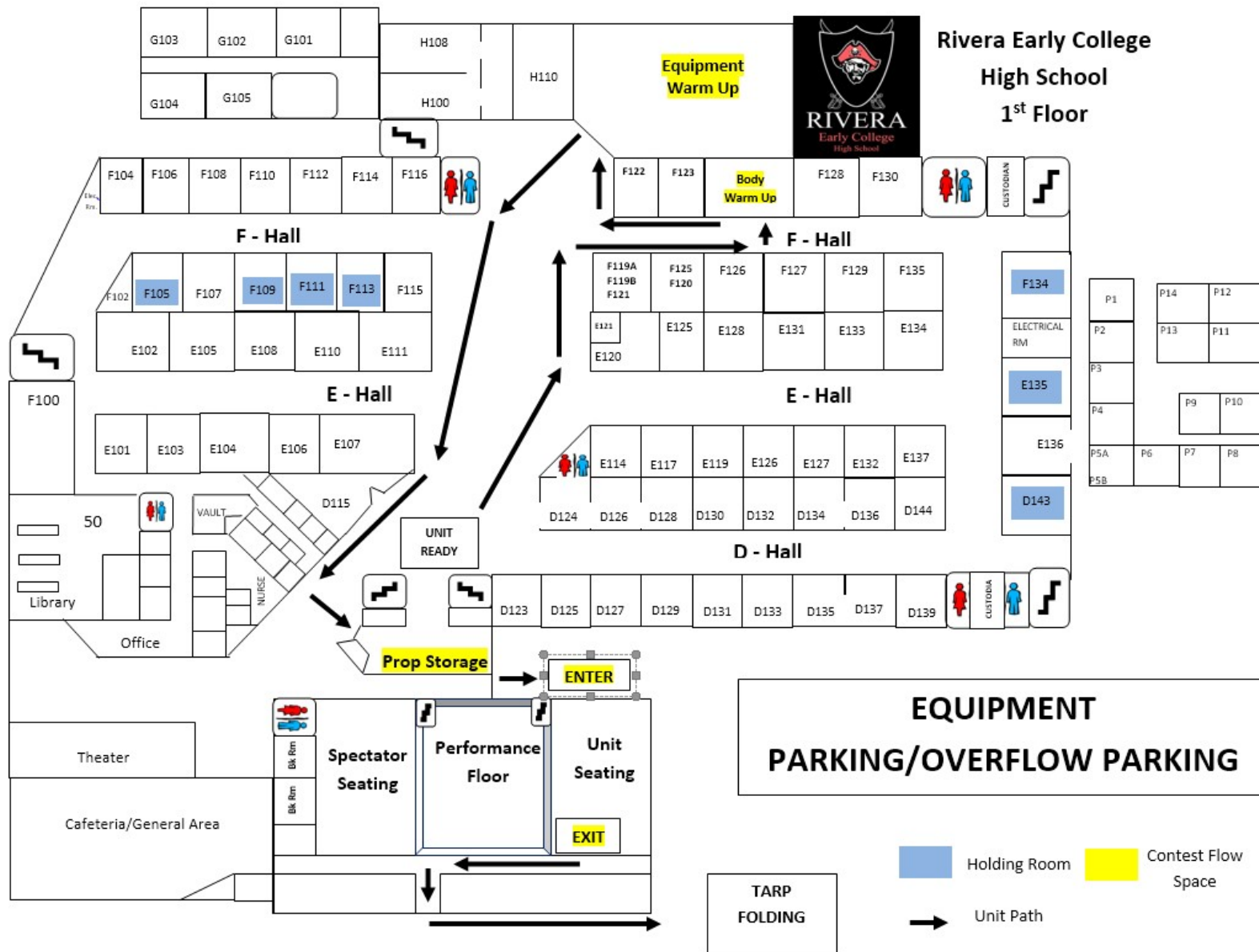



**Riviera Early College
High School
2nd Floor**

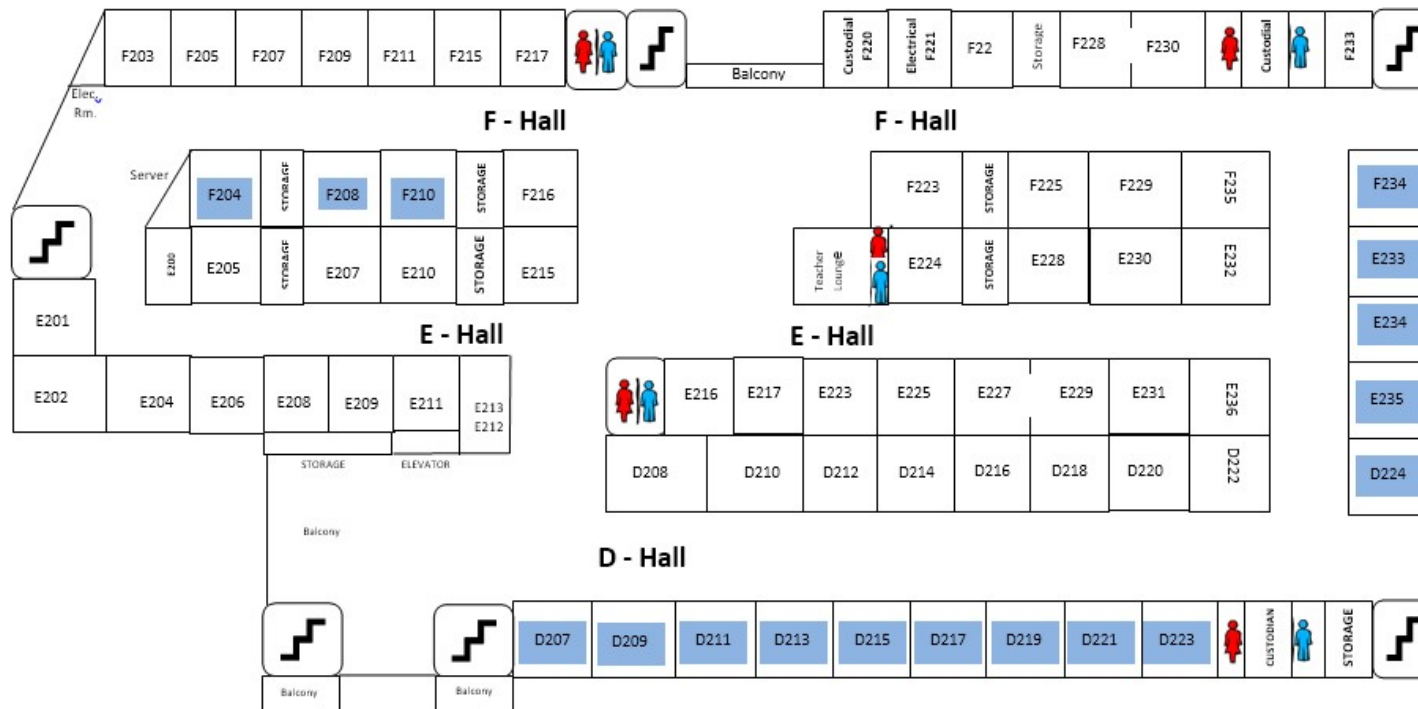

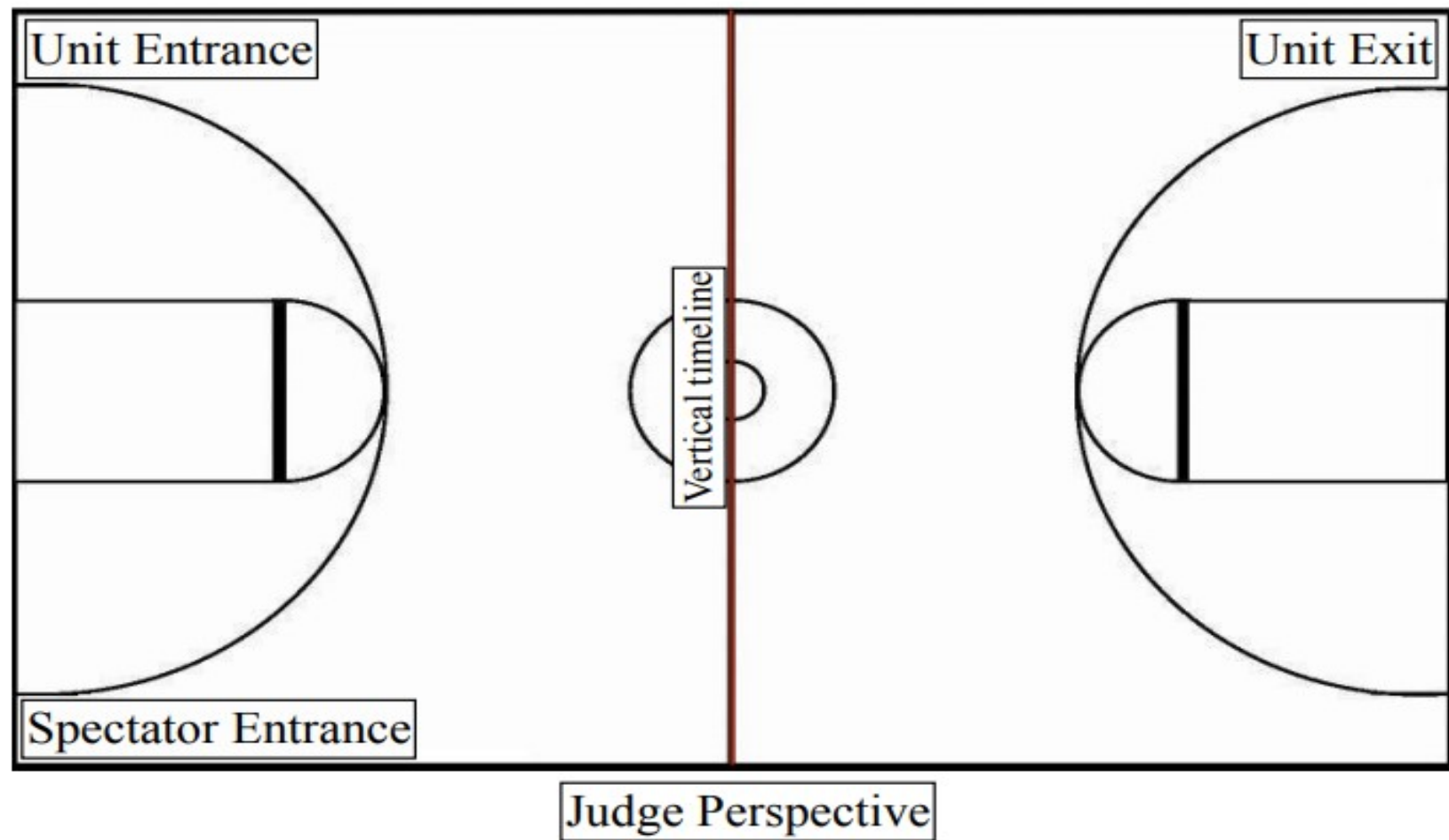



Vermillion Ave.

Ruben M. Torres Blvd.

General

Warm Up

Equipment/Overflow
Bus

Tarp Folding

General Warm Up

Prop Entrance

Spectator Parking

Main Entrance

General Warm Up

Spectator Parking

Bus Parking

Bus Exit

Spectator Entrance

Bus Entrance